

DATE: 2009/11/7 (YY/MM/DD)

Customer : _____

APPROVAL SHEET

RoHS Compliant

PRODUCT: AC ADAPTOR
MODEL: UIA345-12
PART NO. SW3126 UKR006-08
V : 091107

PowerPax UK

Receiver's stamp or signature

RESPONSIBLE	APPROVED	ISSUED
<i>DAVID</i>	<i>MELINDA</i>	<i>TULIP</i>

ISSUES STAMP

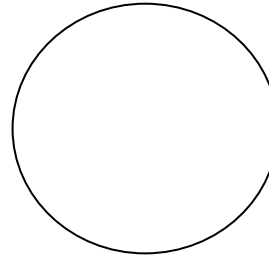

Revised History

NO.	Revised Date	Description	Approved	Issued
	2005.07.21	CHANGE LABEL	<i>MELINDA</i>	<i>TULIP</i>
	2005.09.13	CHANGE LABEL 、 PACKING 、 ADD WEEE LABEL	<i>MELINDA</i>	<i>TULIP</i>
	2005.09.22	CHANGE LABEL 、 CE	<i>MELINDA</i>	<i>TULIP</i>
	2005.09.26	CHANGE LABEL	<i>MELINDA</i>	<i>TULIP</i>
	2006.01.04	CHANGE LABEL	<i>MELINDA</i>	<i>TULIP</i>
	2008.02.28	CHANGE COVER 、 LABEL & DELETE TEST REPORT FORM	<i>MELINDA</i>	<i>TULIP</i>
	2009.03.09	CHANGE CUSTOMER MATERIAL CODE (PACKING & LABEL)	<i>MELINDA</i>	<i>TULIP</i>

POWERPAX UK LTD.

Unit 7 Albury Close, Reading, Berkshire, RG30 1BD
 TEL:+(0) 118 959 0111 FAX:+ (0) 118 959 0155

Revised History

NO.	Revised Date	Description		Issued
		、 RIPPLE 、 LABEL)	MELINDA	TULIP

1.INPUT SPECIFICATION

2.OUTPUT SPECIFICATION

3.MECHANICAL

4.RELIABILITY

5.ENVIRONMENT

6.OUTLOOKING

7.SAFETY

8.QC CHECK

9.DIMENSION

10.PACKING

11.LABEL

1.INPUT SPECIFICATION

ITEM	SPECIFICATION	MIN	TYPICAL	MAX
AC INPUT VOLTAGE	SINGLE PHASE	100Vac		240Vac
AC INPUT VOLTAGE RANGE	SINGLE PHASE	90Vac		264Vac
AC INPUT FREQUENCY	SINGLE PHASE	47Hz	50/60Hz	63Hz
AC INPUT CURRENT	TYPICAL INPUT VOLTAGE& OUTPUT AT FULL LOAD.		1A	1.2A
AC INRUSH CURRENT	TYPICAL INPUT VOLTAGE& OUTPUT AT FULL LOAD , 25°C .		30A	50A
CEC EFFICIENCY	THE ADAPTOR SHALL ACCORD WITH THE REQUEST OF CEC LEVEL IV	84.38%		
STAND BY CONSUMPTION	THE ADAPTOR SHALL ACCORD WITH THE REQUEST OF CEC LEVEL IV			0.5W
LEAKAGE CURRENT	TYPICAL INPUT VOLTAGE& OUTPUT AT FULL LOAD.			0.25mA

2.OUTPUT SPECIFICATION

ITEM	SPECIFICATION	MIN	TYPICAL	MAX
NOMINAL DC OUTPUT VOLTAGE			12Vdc	
DC OUTPUT VOLTAGE RANGE	TYPICAL OUTPUT VOLTAGE $\pm 5\%$	11.4V		12.6V
LOAD CURRENT		0.0A		3.8A
RIPPLE	TYPICAL INPUT VOLTAGE , TYPICAL LOAD CURRENT , 25°C			300mV
NOISE	TYPICAL INPUT VOLTAGE , TYPICAL LOAD CURRENT , 25°C			400mV
HOLD-UP TIME	AT TYPICAL INPUT VOLTAGE AND FULL LOAD	10mS		
TURN-ON DELAY	TYPICAL INPUT VOLTAGE AND TYPICAL LOAD CURRENT			1S
OVER CURRENT PROTECTION	AUTO RECOVERY			
SHORT CIRCUIT PROTECTION	THE ADAPTOR SHALL NOT DAMAGE BY SHORT TO THE DC OUTPUT GROUND			
OVER VOLTAGE PROTECTION	AUTO RECOVERY			19.5V

*TEST MEASURES

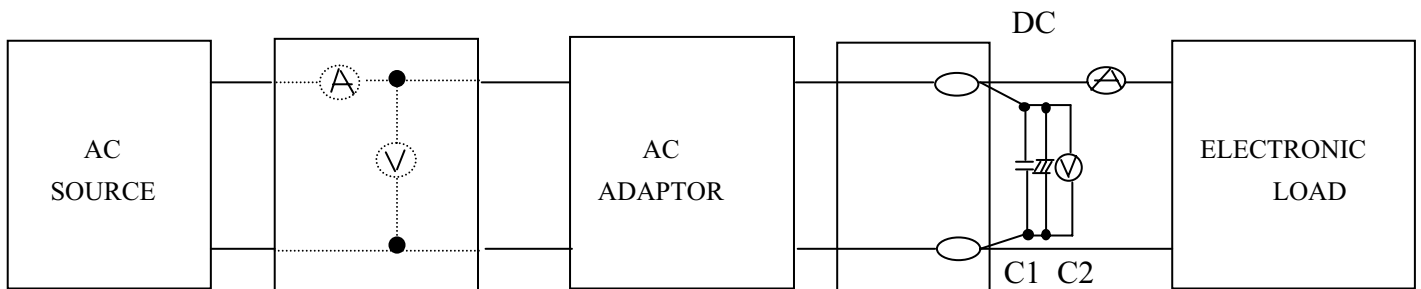

C1: 0.1 μ F CERAMICS CAPACITOR
 C2: 10 μ 50V ALUMINUM CAPACITOR

3.MECHANICAL

ITEM	SPECIFICATION OR TEST CONDITION	ACCEPTANCE CRITERIA
BENDING TEST	NORMAL TEMPERATURE THE CORD SHALL WITHSTAND WEIGHT OF 4.9N,IT SWINGS FROM LEFT TO RIGHT AT AN ANGLE 60 DEG. 1000CYCLE TIMES MINUTES. S/R SHALL WITHSTAND WEIGHT OF 1.0N. IT SWING FROM LEFT TO RIGHT AT AN ANGLE 60DEG. 1000CYCLE TIMES MINUTES. BENDING SPEED 40CYCLE/MIN.	NO SHORT CIRCUIT NO BREAKAGE OF THE CORD
VIBRATION	DURATION: 30 MINUTES AMPLITUDE: 0.35mm FREQUENCY RANGE: 10 Hz...55 Hz...10 Hz SWEEP RANGE: APPROXIMATELY 1 OCTAVE / MIN	THERE SHALL BE NO ABNORMALITY ON THE APPEARANCE STRUCTURE AND OPERATING

4.RELIABILITY

ITEM	TEST CONDITION	ACCEPTANCE CRITERIA
TEMPERATURE UP WITH FULL LOAD	TEST AT SURFACE OF THE CASE WITH TYPICAL AC INPUT AND FULL LOAD IN OUTPUT 50/60Hz	TEMPERATURE RISEN MEET SAFETY APPROVALED AT THE SURFACE OF CASE
HI-POT TEST	BETWEEN INPUT & OUTPUT 3000Vac 3 SECONDS 10mA	NO DAMAGE
INSULATION RESISTANCE	INPUT TO OUTPUT ,DC 500V	>100MΩ
BURN-IN TEST	AT 30°C (±10°C),TYPICAL INPUT VOLTAGE	2~4 HOURS

5.ENVIRONMENT

ITEM	SPECIFICATION OR TEST CONDITION	MIN	TYPICAL	MAX
OPERATING TEMPERATURE		0°C		40°C
STORAGE TEMPERATURE		-20°C		85°C
OPERATING HUMIDITY	NON-CONDENSING	5%RH		95%RH
STORAGE HUMIDITY	NON-CONDENSING	5%RH		95%RH

6.OUTLOOKING

DIMENSION :95.9(L)×43.8(W)×28.5(H)mm typ
 WEIGHT :ABOUT 175g
 AC INPUT TYPE :IEC 320 C8
 DC OUTPUT TYPE :12*5.5*2.1



DC OUTPUT CABLE :USE UL SPT-1 18AWG WIRE
 INDICATION :LABEL
 CASE MATERIAL :94V-0 ABS+PC
 PCB MATERIAL :94V-0

7.SAFETY

COMPLY SAFETY STANDARDS	STANDARD	FILE NO.
CUL	UL60950-1	E201955
CCC MARK	GB4943-2001	2003010907101973
	GB9254-1998	
	GB17625.1-2003	
EK-MARK	K60950	HU10217-4003C

Manufacturer: PowerPax (SHEN ZHEN) CO., LTD.

Factory Address: Industrial Area of Long Men, Da Tian Yang, Song Gang Town, Baoan, Shen Zhen, China.

EMI
VCCI class B , FCC class B , CISPR 22 class B

8.QC CHECK

ALL OF THE QUANTITY SHALL BE CHECKED BEFORE SHIPMENT,CHECK ITEM AS BELOW:

- (1)DC PLUG POLE CHECK
- (2)OCP FUNCTION CHECK
- (3)DC OUTPUT VOLTAGE CHECK
- (4)HI-POT&INSULATION CHECK
- (5)OUTLOOKING CHECK

STANDARD OF RoHS

NO.	chemical substances group
1	Cadmium
2	Chromium(VI)
3	Lead
4	Mercury
5	Polybrominated biphenyls (PBBs)
6	Polybrominated diphenyl ethers(PBDEs)

FOR ENVIRONMENTAL IMPACT SUBSTANCES CONTAINED IN PARTS. COMPLY WITH "RoHS"

THE EUT HAS BEEN TESTED ACCORDING TO THE FOLLOWING SPECIFICATIONS:

EMISSION			
STANDARD	TEST TYPE	RESULT	REMARKS
EN 55022 : 1998+A1:2000+A2:2003	CONDUCTED TEST	MEET	MEETS CLASS B LIMIT
	RADIATED TEST	MEET	MEETS CLASS B LIMIT
EN61000-3-2: 2000,CLASS A	HARMONIC CURRENT EMISSIONS	MEET	MEETS CLASS A LIMIT
EN61000-3-3: 1995+A1:2001	VOLTAGE FLUCTUATIONS & FLICKER	MEET	MEET THE REQUIREMENTS.

IMMUNITY(EN 55024:1998+A1:2001+A2:2003)			
STANDARD	TEST TYPE	RESULT	REMARKS
EN 61000-4-2: 1995+A1:1998+A2:2000	ELECTROSTATIC DISCHARGE IMMUNITY TEST	MEET	MEETS THE REQUIREMENTS OF PERFORMANCE CRITERION A
EN 61000-4-3: 2002+A1:2002	RADIATED,RADIO- FREQUENCY, ELECTROMAGNETIC FIELD IMMUNITY TEST	MEET	MEETS THE REQUIREMENTS OF PERFORMANCE CRITERION A
EN 61000-4-4:2004	ELECTRICAL FAST TRANSIENT / BURST IMMUNITY TEST.	MEET	MEETS THE REQUIREMENTS OF PERFORMANCE CRITERION A
EN 61000-4-5: 1995+A1:2000	SURGE IMMUNITY TEST	MEET	MEETS THE REQUIREMENTS OF PERFORMANCE CRITERION A
EN 61000-4-6: 1996+A1:2000	IMMUNITY TO CONDUCTED DISTURBANCES, INDUCED BY RADIO- FREQUENCY FIELDS	MEET	MEETS THE REQUIREMENTS OF PERFORMANCE CRITERION A
EN 61000-4-8: 1993+A1:2000	POWER FREQUENCY MAGNETIC FIELD IMMUNITY TEST.	MEET	MEETS THE REQUIREMENTS OF PERFORMANCE CRITERION A
EN 61000-4-11: 1994+A1:2000	VOLTAGE DIPS,SHORT INTERRUPTIONS AND VOLTAGE VARIATIONS IMMUNITY TESTS	MEET	MEETS THE REQUIREMENTS OF VOLTAGE DIPS: 1.>95% 0.5 CYCLE REDUCTION- PERFORMANCE CRITERION A 2. 30% 25 CYCLE REDUCTION- PERFORMANCE CRITERION A VOLTAGE INTERRUPTIONS: 1.>95% 250 CYCLE REDUCTION- PERFORMANCE CRITERION B

9.DIMENSION

CASE TOLERANCE: $\pm 0.5\text{mm}$

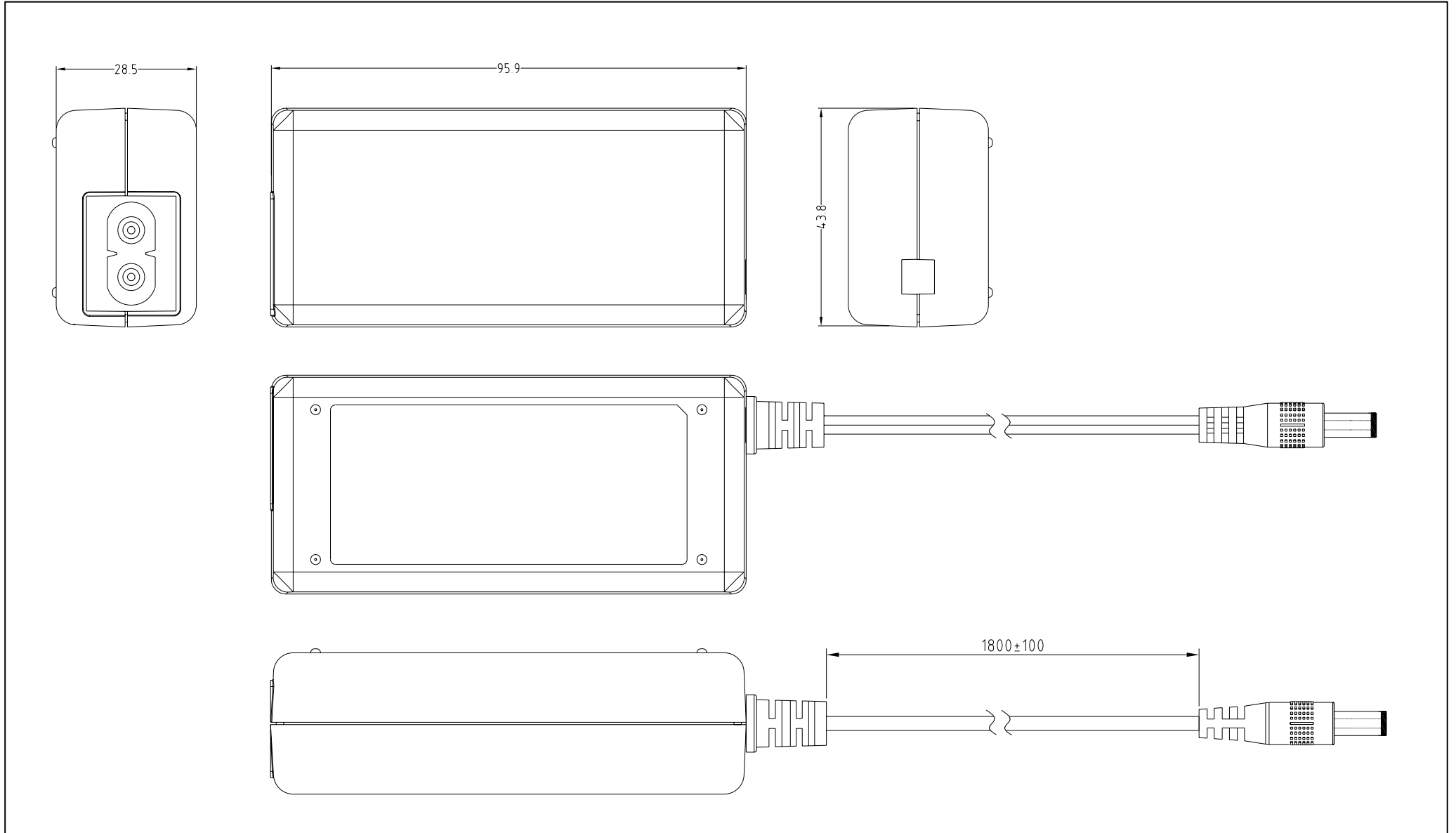

DC PLUG $A*B*C = 12\pm 0.5\text{mm} * 5.5\pm 0.05\text{mm} * 2.1\pm 0.05\text{mm}$
 $D = 1800\pm 100\text{mm}$

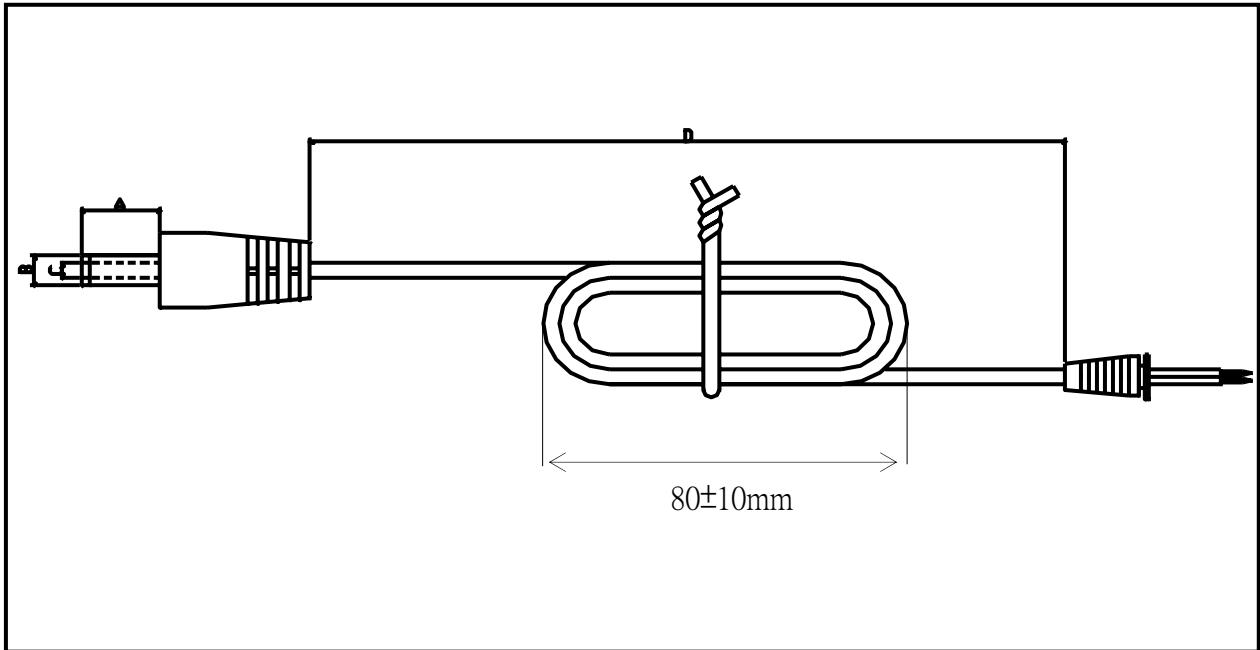

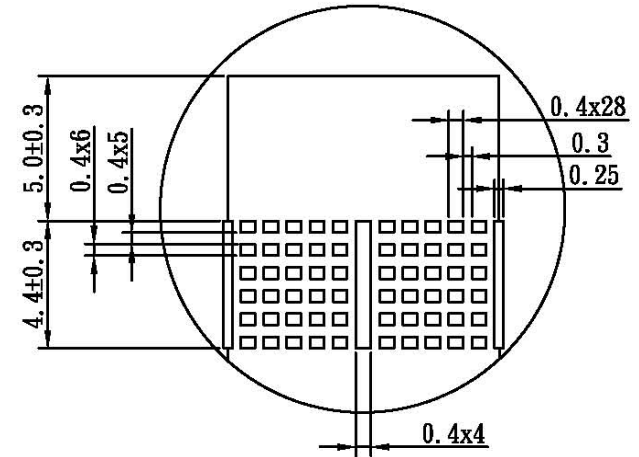
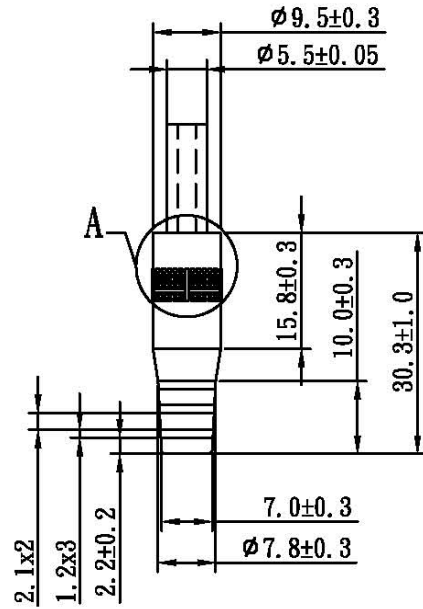

A AMPLIFIED PICTURE

CUSTOMER		TOOLING NO.	HT-51
PART NAME	DRAWING FOR DC PLUG TOOLING		
P/N			
DATE	2004-10-16	UNIT	m/m
RESPONSIBLE	APPROVED	DRAWING	

NOTE:
 THIS TOOLING IS FIT FOR UL SPT-1 (18#、20#);
 JACK IS FIT FOR 5.5*2.1、5.5*2.5 OF THESE NORMAL TYPES &
 STRAIGHT PLUG OF TONOMETER WITH FORK TUNE.

10.PACKING

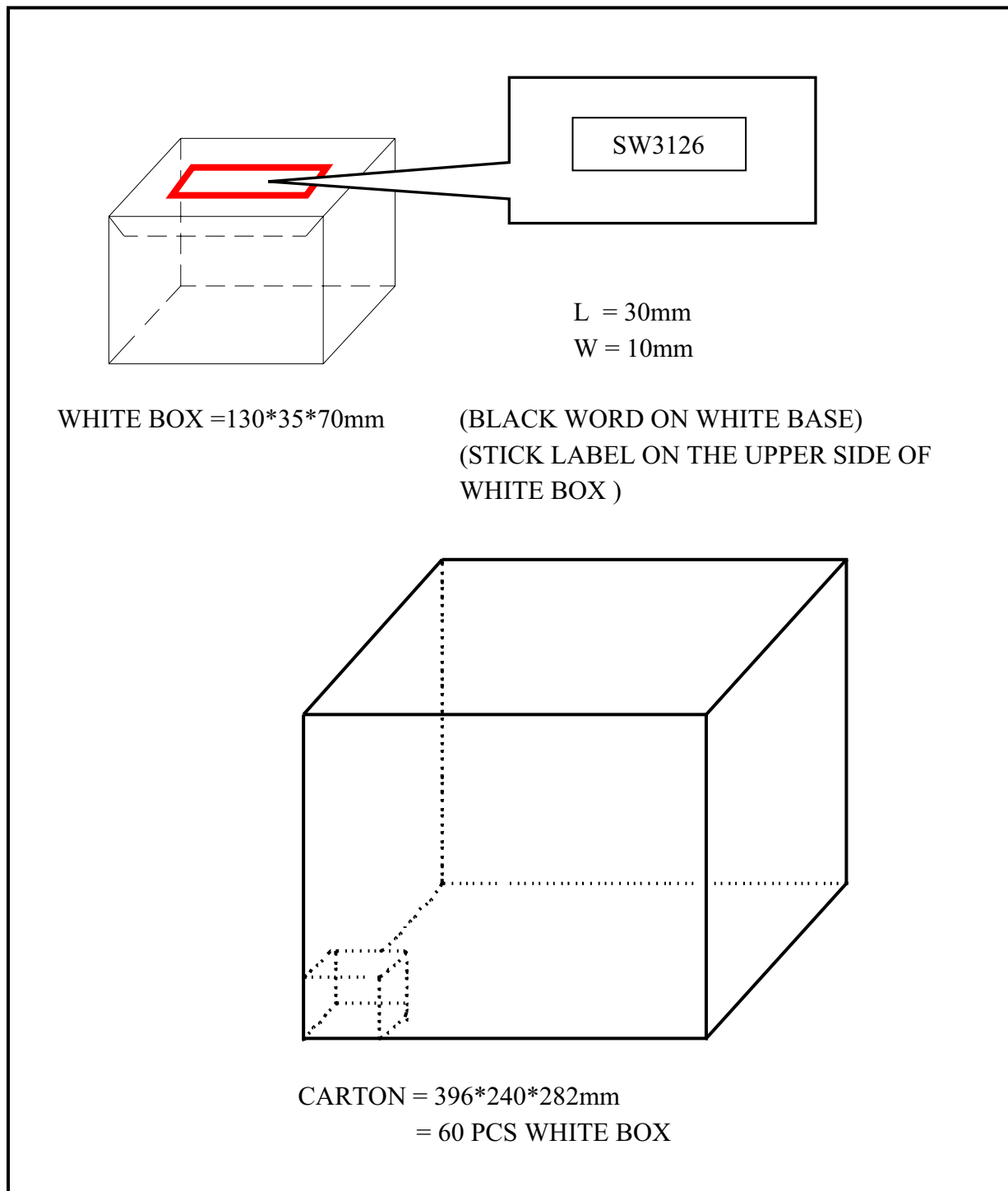

11.LABEL (SILVER WORD ON BLACK BASE)

PowerPax UK

SW3126

www.powerpax.co.uk

(型号) Model No: UIA345-12
 (输入) I/P: AC 100-240V 50/60Hz 1.2A
 (输出) O/P: DC 12V 3.8A



UL
LISTED

I.T.E. POWER SUPPLY
56EK
E201955
LEVEL3

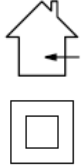





A033180





KETI HU10217-4003C
 Model No: UIA345-12
 Input Rating: 100-240V 50/60Hz 1.2A
 Output Rating: DC 12V 3.8A
 A/S No: (02)6679-7134



L.P.S. 

EFFICIENCY LEVEL:  UKR006-08

优源科技(深圳)有限公司
 S/No. XXX-XXXXXXX
 MADE IN CHINA

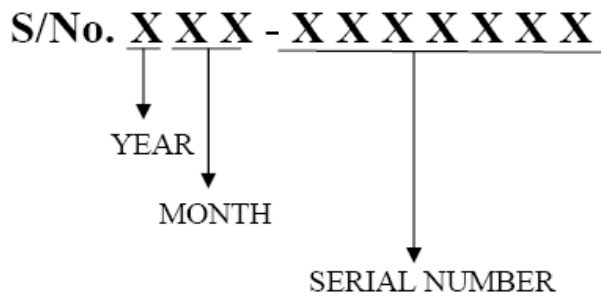
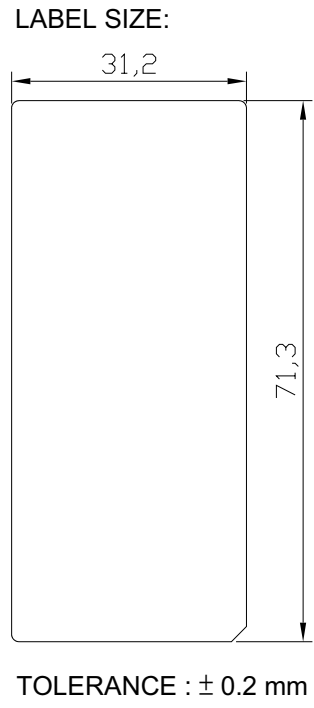



(BLACK WORD ON SILVER BASE)